

Plot File by: aecom\p06\2018 PATH\p06\HKSH11\VA\006.aecommonline\lca\lca\AECOM_DS02_ASI\Documents\60507694_TC\NTE - D&C\CAD PRODUCTION\DRAWING\REPORT\C11C11_111.dgn

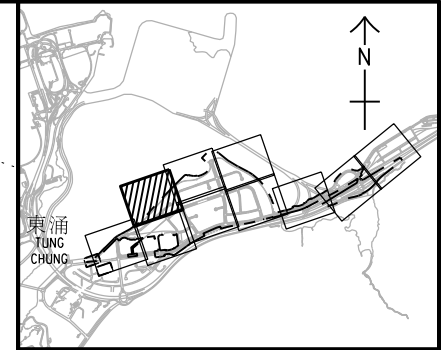
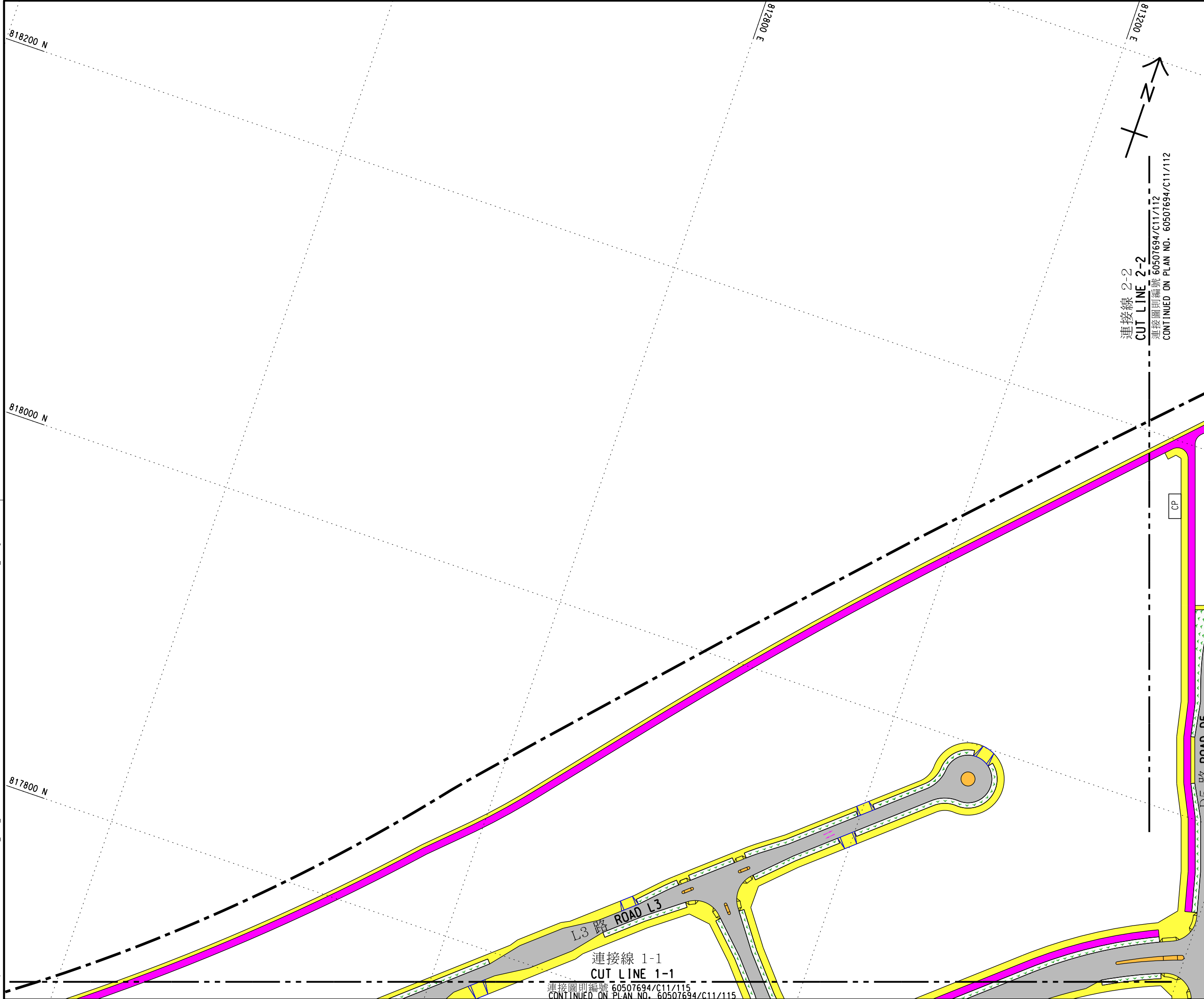

索引圖 KEY PLAN
比例 SCALE 1 : 50000

- 註釋: NOTES:
- 除在其他方面指定外，所有量度以米為單位。
ALL DIMENSIONS ARE IN METRES UNLESS OTHERWISE SPECIFIED.
 - 所有水平均為約數，以米為單位，並在香港主水平基準以上(+)或以下(-)。
ALL LEVELS ARE APPROXIMATE VALUES AND IN METRES ABOVE (+) OR BELOW (-) HONG KONG PRINCIPAL DATUM.
 - 如有需要，施工區界限內部分現有地面行車道、行人隧道、地面行人路、地面單車徑、地面美化市容地帶、高架美化市容地帶和路中預留帶/安全島或會分階段暫時封閉。
SECTIONS OF THE EXISTING AT GRADE CARRIAGEWAYS, SUBWAY, AT GRADE FOOTPATHS, AT GRADE CYCLE TRACK, AT GRADE AMENITY AREAS, ELEVATED AMENITY AREAS AND CENTRAL RESERVES/REFUGE ISLANDS WITHIN THE LIMIT OF WORKS AREA MAY BE TEMPORARILY CLOSED IN PHASES AS AND WHEN REQUIRED.
 - 如有需要，土力、斜坡穩固、渠務、污水收集系統、水務、公用設施和環境美化工程或會在施工區界限內進行。
GEOTECHNICAL, SLOPE STABILIZATION, DRAINAGE, SEWERAGE, WATER, UTILITIES AND LANDSCAPING WORKS MAY BE CARRIED OUT WITHIN THE LIMIT OF WORKS AREA AS AND WHEN REQUIRED.
 - 圖例的詳細資料請參照圖則編號 60507694/C11/110。
DETAILS OF LEGENDS ARE SHOWN ON PLAN NO. 60507694/C11/110.

工程名稱 PROJECT TITLE
工務計劃項目第 7786CL 號
東涌新市鎮擴展
(東涌東及 P1 路 (東涌東至大蠔段) 道路工程)
PWP ITEM NO. 7786CL
TUNG CHUNG NEW TOWN EXTENSION
(TUNG CHUNG EAST AND ROAD P1
(TUNG CHUNG EAST TO TAI HO SECTION)
ROAD WORKS)

圖則名稱 PLAN TITLE
根據《道路 (工程、使用及補償) 條例》
(第 370 章) 而在憲報公布之圖則
PLAN FOR GAZETTING UNDER ROADS
(WORKS, USE AND COMPENSATION)
ORDINANCE (CHAPTER 370)

十張之第一張
SHEET 1 OF 10

圖則編號 PLAN NO.
60507694/C11/111
比例 SCALE
A1 1:1000

辦事處 OFFICE
可持續大嶼辦事處
SUSTAINABLE LANTAU OFFICE



土木工程拓展署
CIVIL ENGINEERING
AND DEVELOPMENT
DEPARTMENT

連接線 1-1
CUT LINE 1-1

連接圖則編號 60507694/C11/115
CONTINUED ON PLAN NO. 60507694/C11/115

連接線 2-2
CUT LINE 2-2
連接圖則編號 60507694/C11/112
CONTINUED ON PLAN NO. 60507694/C11/112

CP

D5 路 ROAD D5

L3 路 ROAD L3